

3" HYDRAULIC SUBMERSIBLE CENTRIFUGAL SCREW PUMP

MODEL S3SCR

3" (75 mm) Discharge

The S3SCR is ideal for pumping high viscosity liquids such as crude oils, latex, molassas and refinery wastes using a positive displacement screw. When pumping lighter materials, the impeller acts as a centrifugal type providing high capacity. Typical uses include oil skimmers and cargo pumping.



FEATURES

- Unique Centrifugal Screw Impeller allows pumping of liquids with Viscosities to 250,000 CST
- Small Overall Size allows for use in Confined Spaces
- Oil Lubricated Seals (Can Run Dry)
- Ceramic Coated Case for Abrasion Resistance
- Wide Range of Performance
- Safe Hydraulic Drive can be used where Electric Power is Hazardous or Impractical
- Will Pass 1.5 inch Semi-Solids
- Can be used In-Line as a Booster Pump
- Operates With Our Power Units to 25 HP or other Hydraulic Power Sources with flows of 6 - 11 GPM

SPECIFICATIONS

WEIGHT:.....	43 lbs. (20 kg)
HEIGHT:.....	16 1/2" (42cm)
DIAMETER (@ widest point):.....	9 1/4" (23.5cm)
DISCHARGE:.....	3" NPT (F)
INLET FLANGE:.....	3" 125# ASA
SOLIDS HANDLING:.....	1 1/2" (38 mm)
HOSE PORTS:.....	1/2" JIC
PUMP BODY:.....	Heat Treated Aluminum
IMPELLER / SCREW:.....	CD4MCU Stainless Steel
SUCTION CASE:.....	Ceramic Coated
ELASTOMERS:.....	Buna N (Std)
HYDRAULIC OIL:.....	.214-320 s.s.u. @ 100°F (64°C)
INPUT FLOW:.....	Max. 11 GPM (42 LPM)
OPERATING PRESSURE:.....	Max. 3000 PSI (204 Bar)
POWER SOURCE:.....	Any Open Center Hydraulic System

A0103

Specifications subject to change without notice.

Model S3SCR Overall Dimensions

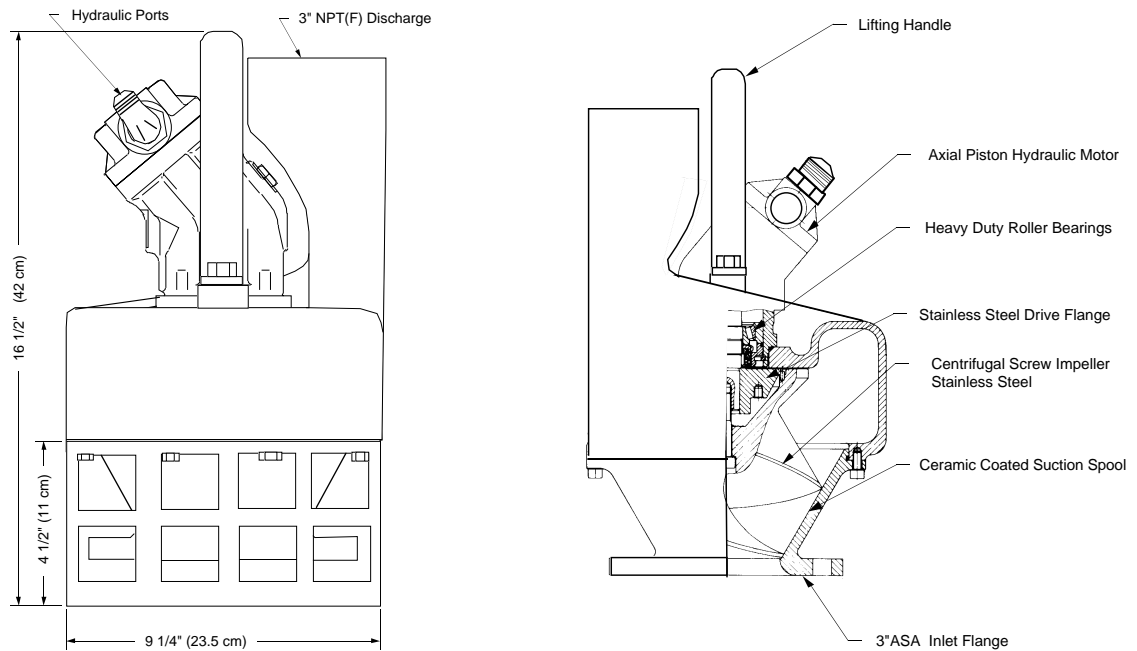

S3SCR Typical Performance

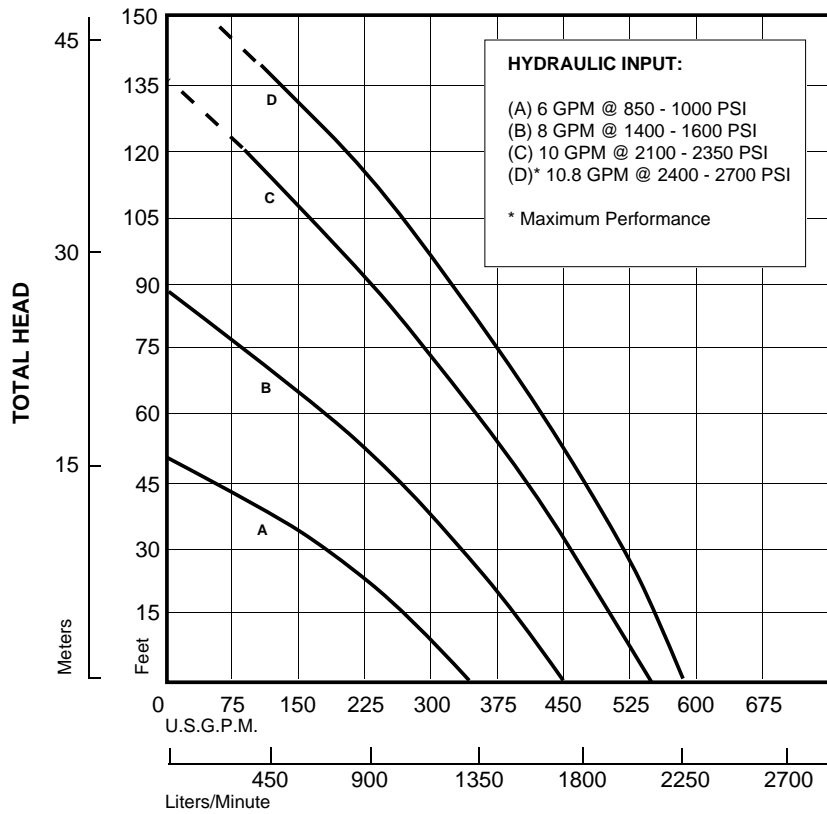

Curves are based on pumping water at 60° F. For Performance Curves other than shown above, Consult Factory.