



Inline 3" Circulator Pumps

NEW
FOR
2007

- **Cast Iron or Lead-Free Bronze Construction**
- **Buna-N Mechanical Seal and Casing O-ring**
- **Lead-Free Bronze Impeller**
- **Includes Mounting Flange Kit for 3" NPT**
- **Max Working Pressure 150 PSI**
- **Max. Temperature 200°F (94° C)**
- **Max. Flow 150 GPM**
- **Max. Head 28 ft. (12 PSI)**
- **Single Phase or Three Phase TEFC 56C Motor**



**5740-97 Bronze
Circulator Pump**

Patterson Inline Circulator Pumps are designed for continuous duty industrial/commercial systems. Pumps are available in a variety of material configurations to meet your specifications. Pumps are powered by a 56C NEMA frame electric motor with 1/2" conduit connection. Pumps are interchangeable with other manufacturers, see cross reference on specification page.

Patterson Inline Circulator Pumps are reliable, cost effective and low maintenance. Pumps are available "Off-the-Shelf" for fast 24 hour shipment. For use with non-flammable liquids which are compatible with pump component materials.

Performance of Inline Circulator Pumps



Capacity in US Gallons per Minute @ 1725 RPM

*Convert to PSI, divide by 2.31 Liquid-Water specific gravity 1.0

Inline 3" Circulator Pumps

Pump Dimensional & Specification Data

C.Iron Model	Curve	WT. (lbs.)	Bronze Model	WT (lbs.)	HP	PH	ENC	VAC 60hz	FL AMPS	A*	B	C	D	E	F	G
5735-95	A	72	5735-97	78	1/3	1	TEFC	115/230	7/4	14	10	3	1.12	5	3	5.05
5736-95	A	69	5736-97	75	1/3	3	TEFC	230/460	2/1	14	10	3	1.12	5	3	5.05
5730-95	B	77	5730-97	84	1/2	1	TEFC	115/230	9/5	14	10	3	1.12	5	3	5.05
5731-95	B	71	5731-97	77	1/2	3	TEFC	230/460	3/2	14	10	3	1.12	5	3	5.05
5745-95	C	83	5745-97	90	3/4	1	TEFC	115/230	12/6	15	12	3	1.12	5	3.25	5.05
5746-95	C	77	5746-97	84	3/4	3	TEFC	230/460	3/2	15	12	3	1.12	5	3.25	5.05
5740-95	D	90	5740-97	97	1	1	TEFC	115/230	14/7	15	12	3	1.12	5	3.25	5.05
5741-95	D	84	5741-97	91	1	3	TEFC	230/460	4/2	15	12	3	1.12	5	3.25	5.05

NOTE: Electric supply for ALL motors must be within $\pm 10\%$ of nameplate voltage rating (Ex. 230V $\pm 10\%$ = 207 to 253)

NOTE: Dimensions have a tolerance of $\pm 1/8"$

When ordering add the correct -9x suffix to model number indicating material selection

*This dimension may vary due to motor manufacturer's specifications

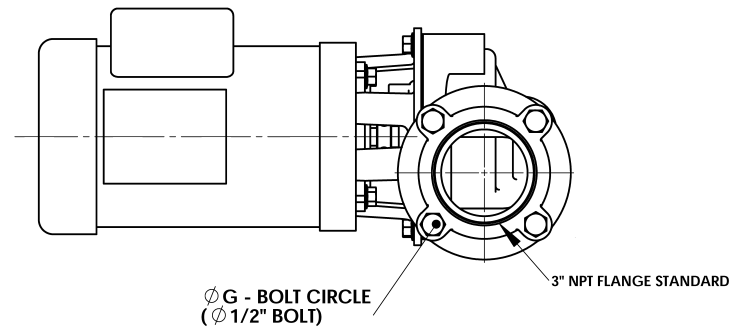
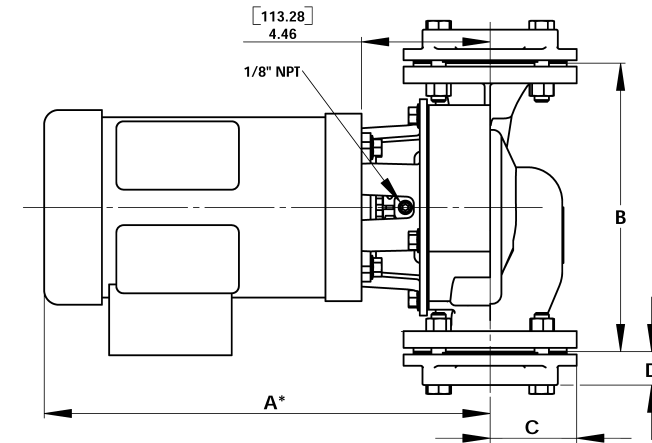

Pumps are designed to mount horizontally or vertically

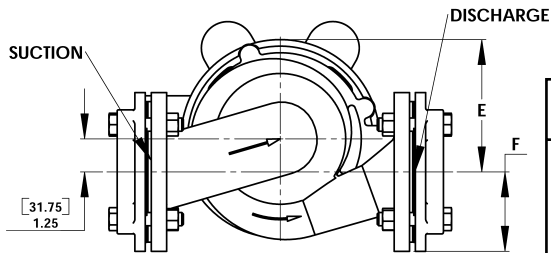

Manufacturers Cross Reference

AMT SERIES	Flange to Flange Width	Bell & Gossett Series (C.Iron)	Bell & Gossett Series (Bronze)	Armstrong Series	TACO Series	Dayton (C.Iron)
5735/5736	10	LD3	LD3AB	S-45	122	4RC99
5730/5731	10	HD3	HD3AB	S-46	131	4RD12
5745/5746	12	PD-35S	PDB35S	S-55	132	4RD13
5740/5741	12	PD-37S	PDB37S	S-56	133	4RD14

Standard Features

- Mounting Flange Kit for 3" NPT, which includes (2) flanges, (2) gaskets, and fasteners
- 4-Bolt flange allows 360° mounting rotation in 90° increments
- 1/8" NPT seal wash/vent port
- Buna-N carbon/ceramic mechanical seal and O-rings
- Stainless Steel (300 series) Stub Shaft
- High Efficiency Closed Impeller
- Standard NEMA 56C motor mounting dimensions
- Available in either Single Phase or Three Phase TEFC 56C Motors