

Heavy Duty & Medium Duty Compact Gear Pump

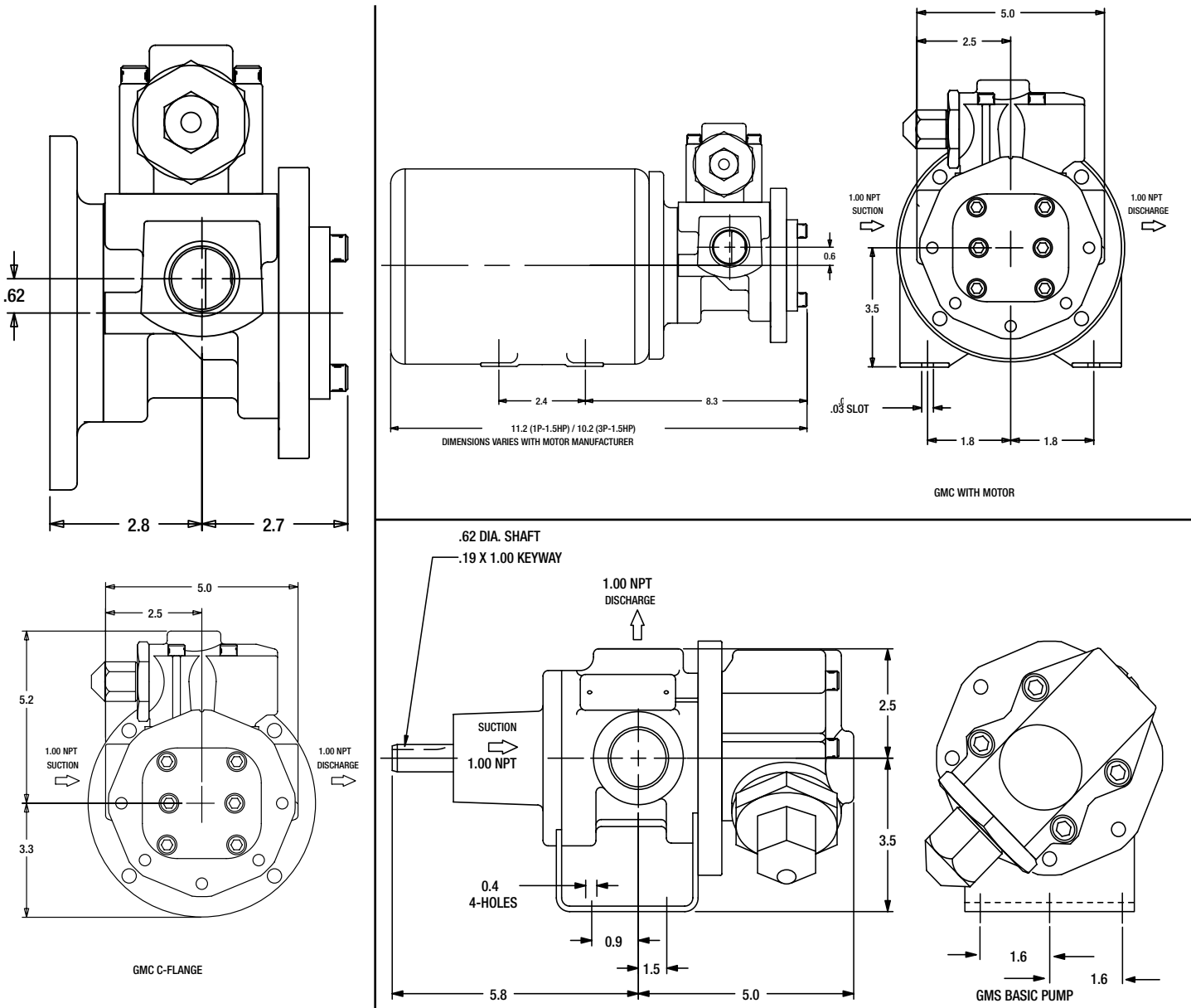

Model No.	Description/ Type of Pump	Ship Wt (Lbs.)	Driver Type & HP	Port size Suc x dis (NPT)	Basic Construction	Seal Type & Elastomer/ Faces	VAC	FL Amps	Motor Enclosure
GMS1DE3/40C	Standard Pump w/car Flex cplg shaft	19	NA	1X1	Cast Iron	Viton®*/ Car, Cer	NA	N/A	NA
GMC1DE3/40C	Compact Pump w/car C-Flange	26	NA	1X1	Cast Iron	Viton®*/ Car, Cer	NA	NA	NA
GMC1DE3-E 1.5 1P	Compact Pump w/car C-Flange	59	1P TEFC 1-1/2 HP	1X1	Cast Iron	Viton®*/ Car, Cer	115/230	18/9	56C
GMC1DE3-E 1.5 3P	Compact Pump w/car C-Flange	59	3P TEFC 1-1/2 HP	1X1	Cast Iron	Viton®*/ Car, Cer	230/460	5/2.5	56C
GMC1DE3-X 1.5 1P	Compact Pump w/car C-Flange	59	1P X-Proof 1-1/2 HP	1X1	Cast Iron	Viton®*/ Car, Cer	115/230	19/9.5	184C
GMC1DE3-X 1.5 3P	Compact Pump w/car C-Flange	59	3P X-Proof 1-1/2 HP	1X1	Cast Iron	Viton®*/ Car, Cer	230/460	5/2.5	56C

*Viton® is a registered trademark of DuPont

Standard Features

- Cast Iron construction with Viton® seal, carbon bushing and high strength iron gears
- Maximum Viscosity of 1500 SSU
- GMC Maximum Pressure of 200 PSI.
- GMS Maximum Pressure of 150 PSI.
- Maximum Temperature 300° F
- 11 GPM at 1750 RPM
- 1" NPT connections
- Adjustable relief valve set at 75 PSI.

WARNING: Do not use in explosive atmosphere or for pumping volatile flammable liquids.

See price book page 44

The Gorman-Rupp Company reserves the right to discontinue any model or change specifications at any time without incurring any obligation.

CP115-116/0904

